

# KOSHIHARA LAB.

Symbiosis of forests and city - Traditional wooden buildings to Metropolitan timber buildings -



Department of Human and Social Systems

Timber Engineering

Department of Architecture, Graduate School of Engineering

<http://wood.iis.u-tokyo.ac.jp>

## Symbiosis of Forests and Cities: The Future of Timber Building

Timber building, which utilizes forest resources, encompasses a wide range of types -from traditional wooden building and wooden houses supporting daily life to large-scale public buildings and, more recently, high-rise timber buildings- each presenting its own unique challenges. Our laboratory specializes in construction systems and structural engineering, and we are dedicated to addressing the challenges associated with these diverse forms of timber architecture. In recent years, our activities have focused particularly on the promotion of urban timber construction, the reuse of timber as a renewable resource, and the preservation of modern timber architecture.

### The Possibilities of Urban Timber Construction

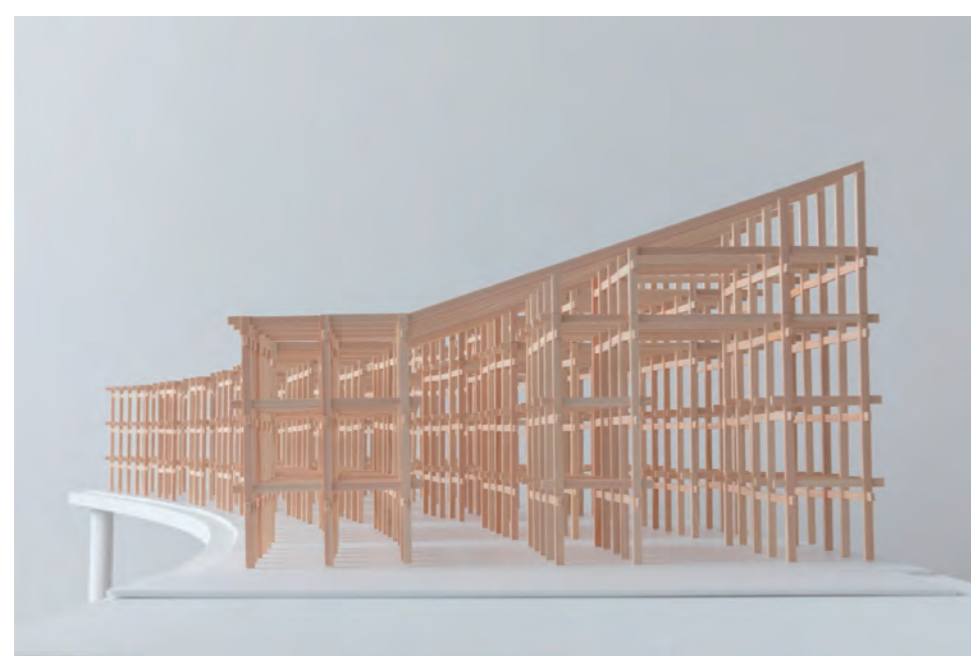

Standard Dimensions



New Construction Method:  
CLT Folded Panel  
Construction

### Timber Architecture as a Circular Resource

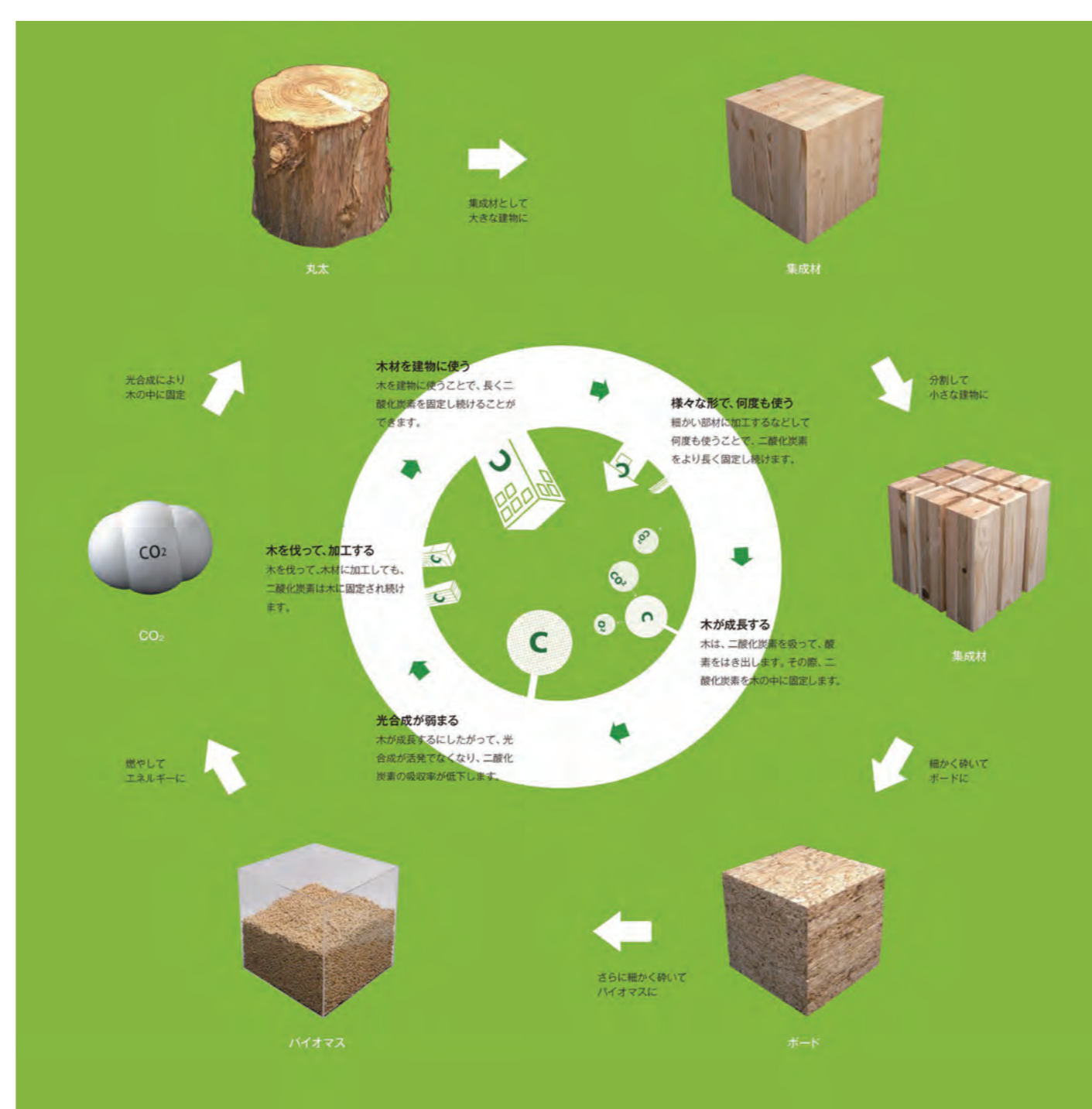

Reuse



Relocation

### Preservation of Modern Wooden Architecture, etc.

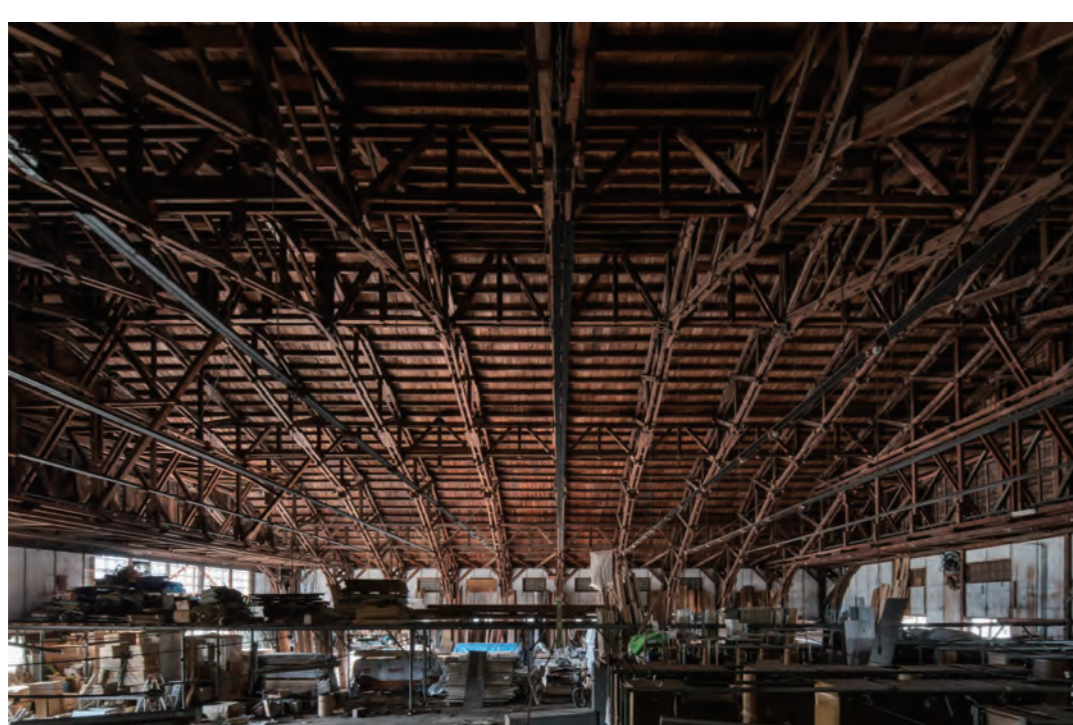

Modern Timber  
Construction



Heritage of War



Naka-naka Heritage



Cutting Preservation