

KAWAZOE LAB.

Design of Architecture



Department of Human and Social Systems
Open Engineering Center

Design of Architecture

Department of Architecture, Graduate School of Engineering

<http://www.kwz.iis.u-tokyo.ac.jp>

Defining New Values in Architecture

1. To discover beauty in things that are not yet recognized as beautiful
2. To construct new relationships between architecture and the city
3. To generate new spatial experiences through these practices



The Knowledge Center of Indian Institute of Technology, Hyderabad, India



The Grand Library of the University of Tokyo, Tokyo, Japan

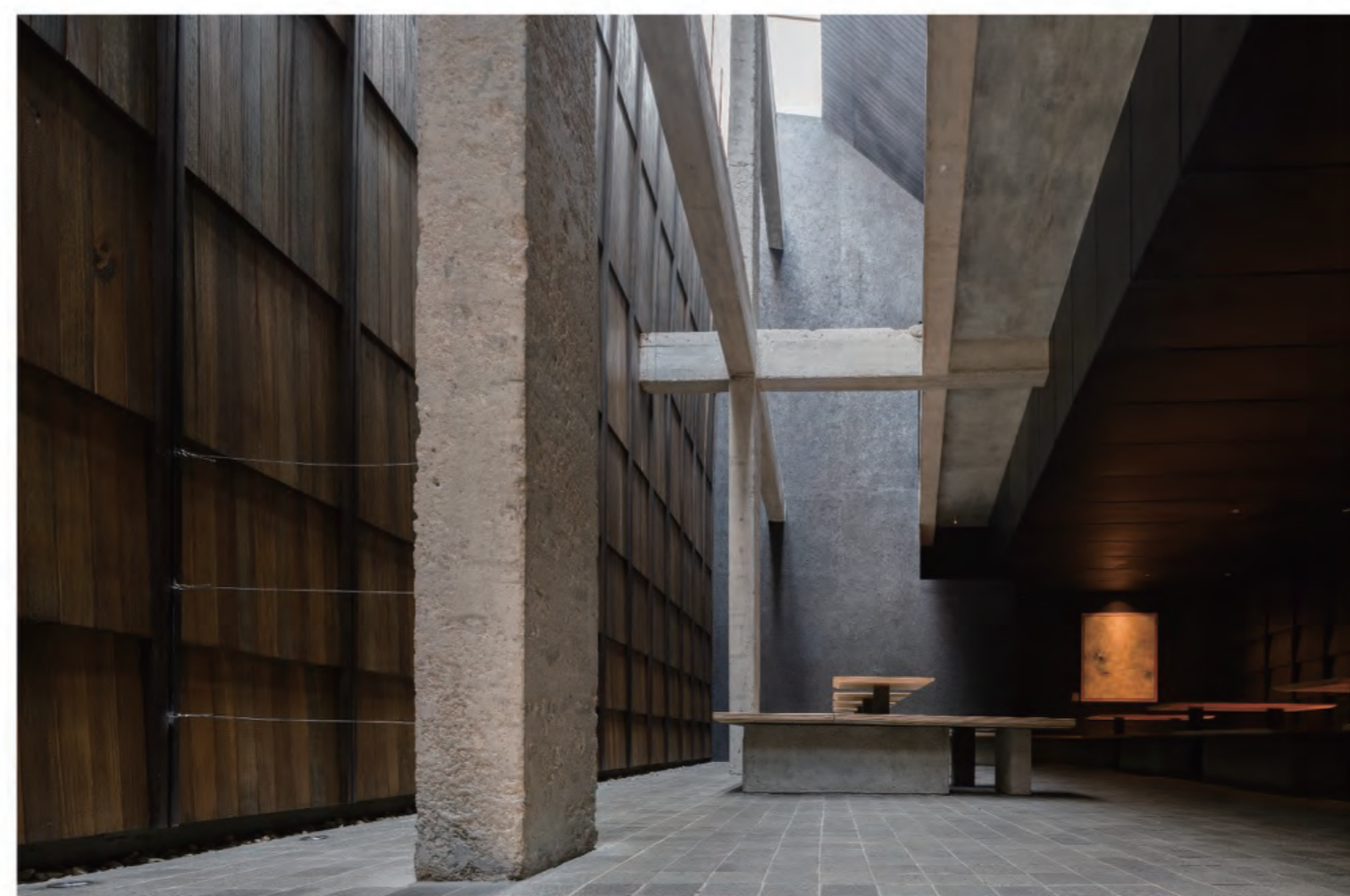

Kurasu Batam, Batam, Indonesia

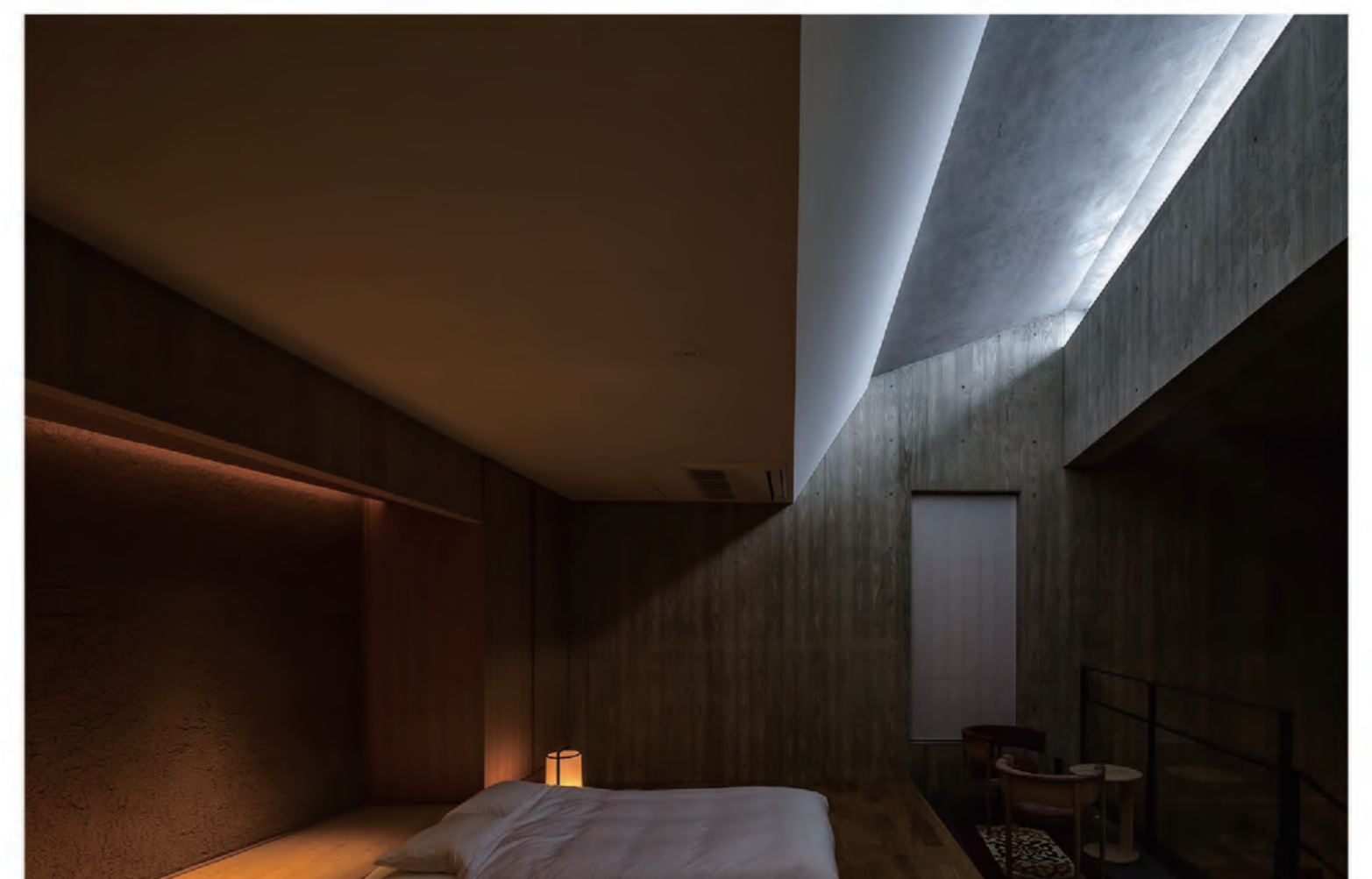

Bou You Rou, Fukui, Japan

