

MAKINO LAB.

[Urban Regeneration by Mobility]

Advanced Mobility Research Center

Traffic Management, Urban Planning

たなカー (Mobile Facility) & ぶらっと (Small Public Space)

Moving function

In drawing to Aging Society and Sustainable Society, what Urban Design is adequate to sustain living in local area? One possible formula for regeneration in local area is to build a facility as a stronghold in order to assemble people. However, we recognize limitation of this classic formula. Holding function into building - this classic model might mean the end of supply of service to local community. It may fairly be presumed that demand is needed for maintaining facility; however, this presupposition might collapse in future society.

Moving function- is our proposal. This new system enables to supply continuous social services which suit to community's rise and fall.

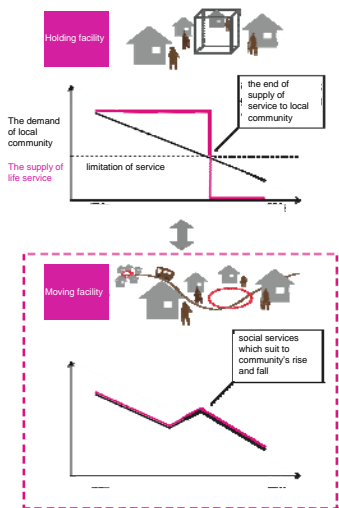

たなカー & ぶらっと

Moving functions, not holding function into building - this is our proposal. Carrying function by car, visit many different areas, supply services in each area. There might be a car with medical function, or public office service. This new system shows that car can carry networks into community and it sustains life service. In order to design cars carrying function, networks, and systems, we believe that it enables to supply extensive life service and it also produces attractive space in a community. Therefore, we propose たなカー which means mobile facility, and ぶらっと which means small public space.

When たなカー comes and stays for few hours, people can use the facility moved by たなカー around them homes. たなカー produces a space which people can receive life service and a space for communicating among local people. This is the conversion of mobility carrying people to "center" to mobility which itself carries "center" to people.

ぶらっと is a place which たなカー stands, and it produces a small public space that people can assemble for communicating. It is hopefully set in 300-400 meters in each, so that both elders and children can access by themselves. ぶらっと can be a new whereabouts for everyone.

たなカー たなカー is a facility which people can reach easily, just like a shelf in a room. Remodeling existent mobile catering car, it enables to produce a space that unifies with station.



ぶらっと In front of the house we can see a restaurant or library when たなカー visits. If the system will be developed, more than two functions can be combined together, and it produces communicating space that crosses generation.

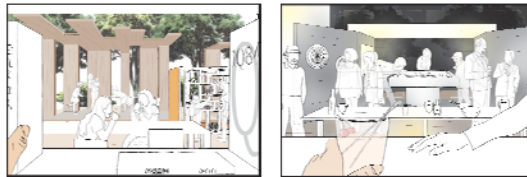

For future society

たなカー and ぶらっと enables 4 possibilities.

1. By using a car, people receive service around their homes.
 2. たなカー and ぶらっと convert frequency to visit.
 3. たなカー and ぶらっと convert places to visit.
 4. たなカー and ぶらっと enable to combine several functions.
- Moving function enables to supply flexible life service to communities that face several social changing problems. Moving function corresponds to needs in each area adaptably; therefore it is significant in keep changing society.

The supply of life service



Keeping the lifestyle in local community



Efficient Development



Combining "center" to "surround"



Field Kashiwa-village, Kashiwa city, Chiba

Aging new town

Kashiwa village is a new town that has been developed since 30 years ago, located 1km from Kashiwa-tanaka station. This town will face aging rapidly, however, shopping arcade in center of the area has been declined, and enough facilities for living are now almost disappeared. In addition, because of the time of development and topography, it is difficult to build communities.

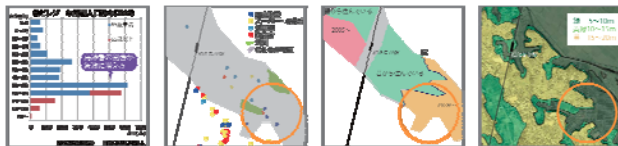

Grasping needs from residents, and think together

Considering necessary function for a densely populated town, we seek function that should be left, and function that should be carried.

What we need for achieving our goals is to promote understanding of our proposal with residents, and grasp their needs. In order to do so, we have presented our proposal to residents through exhibition and workshops, and also we sent out questionnaire to 1600 households to investigate residents' actual conditions of living and future problems. Based on these above, we've considered the best styles of たなカー and ぶらっと.

This year, we will perform experiments on actual use of たなカー. We've did an experiments of たなカー with café and たなカー with bar in order not only to verify effects of たなカー but also to build cooperate community among residents.

As for ぶらっと, we've did two experiments in garden and garage at homes. Last year, we made たなカー experimentally. By developing this with considering multipurpose design of light track, we will build new model of たなカー.



Proposal

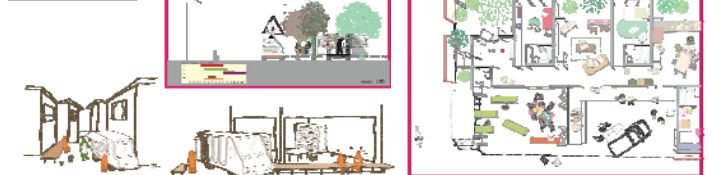

Experiment

